

NOTES:

- A. CABINET WEIGHT 75.0 LBS [34.09 KG]
- B. SHIPPING WEIGHT 81.0 LBS [36.81 KG]

REVISIONS				
ZONE	REV.	DESCRIPTION	DATE	APPROVED

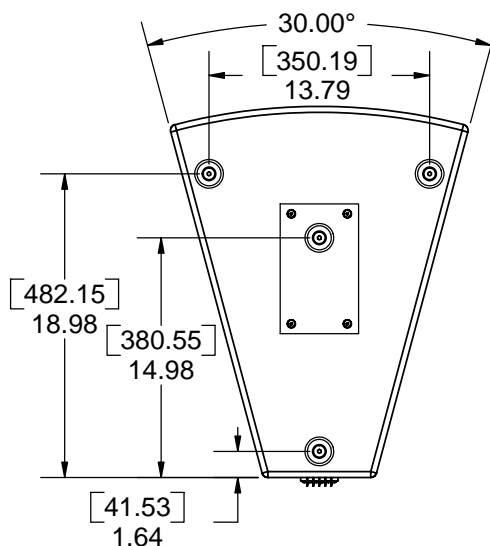
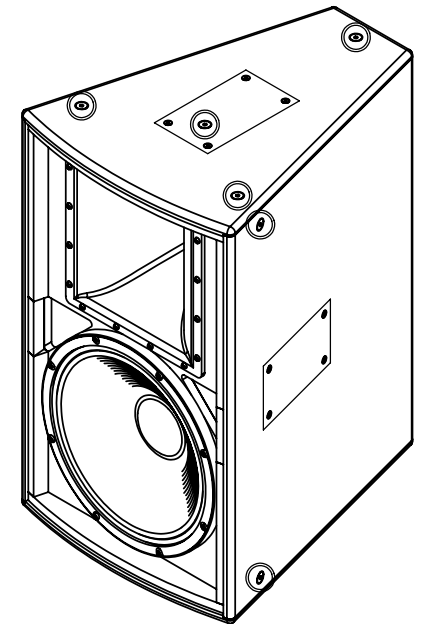
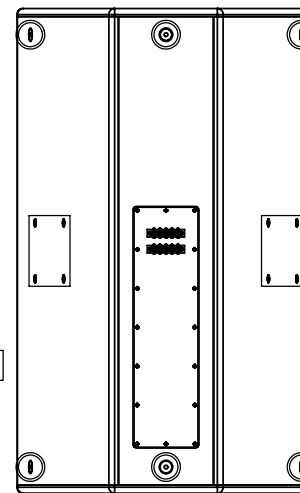
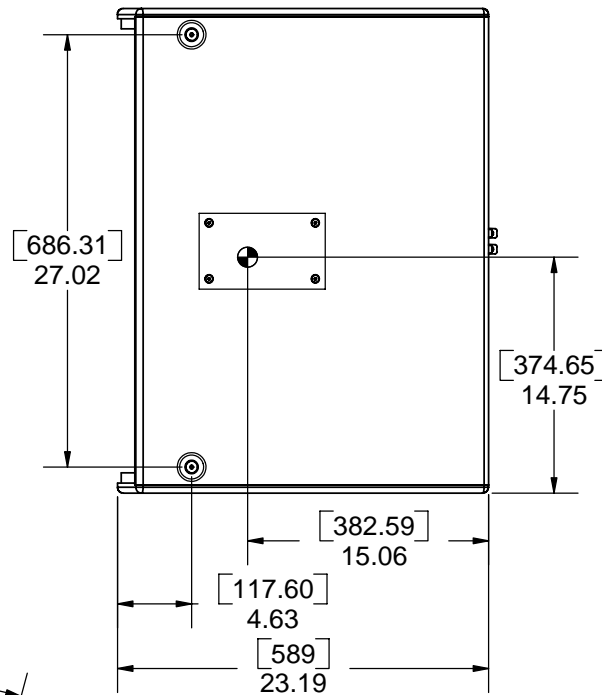
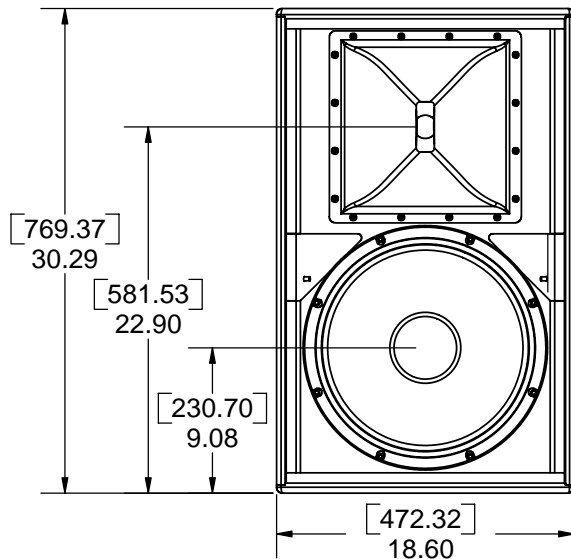

PROPRIETARY AND CONFIDENTIAL
THE INFORMATION CONTAINED IN THIS
DRAWING IS THE SOLE PROPERTY OF
McCauley Sound Inc. ANY
REPRODUCTION OF SAID PRODUCT, IN
PART OR AS A WHOLE WITHOUT THE
WRITTEN PERMISSION OF
McCauley Sound Inc. IS PROHIBITED.

PRIMARY UNITS US CUSTOMARY
SECONDARY UNITS SI
TOLERANCES:
LINEAR: $\pm 0.125"$ UCS, $\pm 3.17E-3$ m SI
ANGULAR: $\pm 1^\circ$
BEND $\pm 5^\circ$
WEIGHT: ± 0.1 lb UCS, BY MASS ± 0.045 kg SI
STANDARD FINISH
Black ProCoat
OPTIONAL FINISHES
White
ORDERING OPTIONS
P, PW, W

NAME		DATE
DRAWN	RM	071706
CHECKED	RM	071706
● Denotes Center of gravity		
□ 5/18 X 18 T-NUT FOR 120 SERIES OMNI MOUNT		
○ 3/8 X 18 FLY POINT		
DRAWING NOT TO SCALE		

McCauley Sound Inc.
16607 Meridian Ave E
Puyallup, WA 98375
(ph 253-848-0363) (fax 253-841-3050)
www.mccauleysound.com
www.linearray.com

SIZE	REV.
A ID3.115-66	1